

M-37

CENTER ROAD

# KINGSFIELD ESTATES

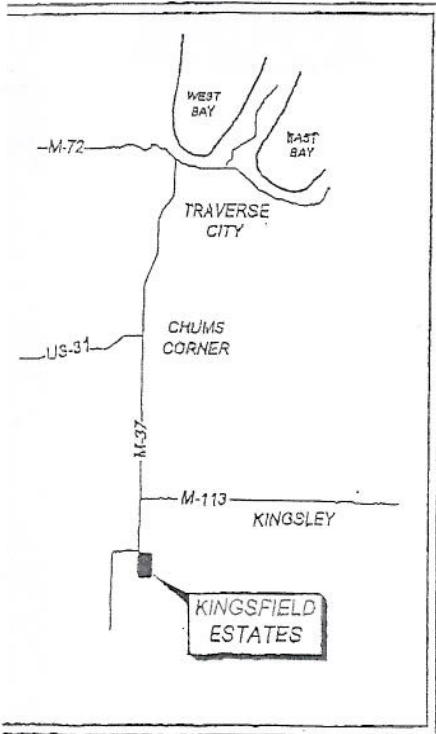
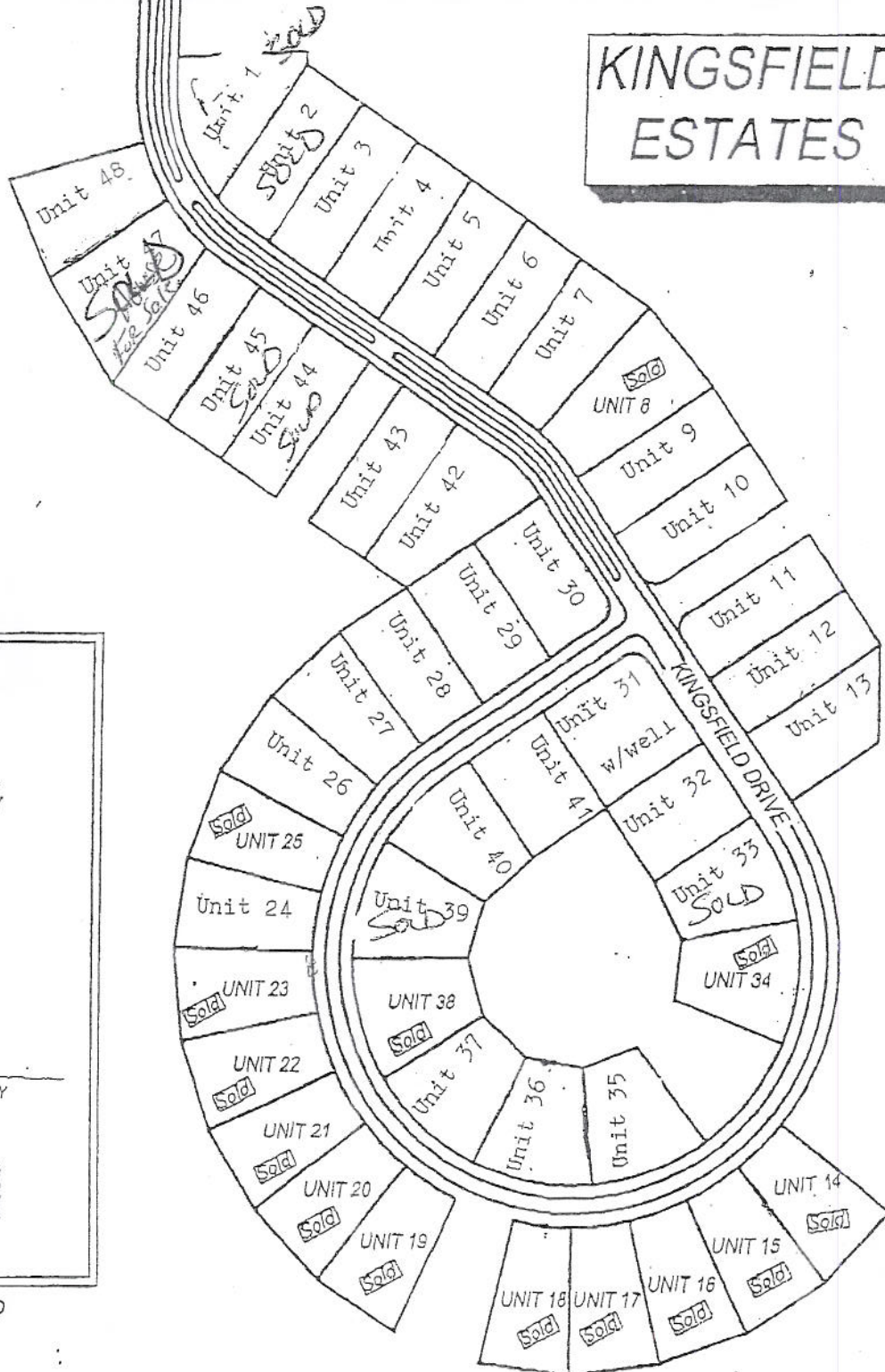

VICINITY MAP

Revised 04-05

PREPARED BY:

3800 RENNIE SCHOOL ROAD  
P.O. BOX 8150  
TRAVERSE CITY, MI 49699-8150  
(231) 943-3443  
FAX (231) 943-6599



PROJECT INFORMATION:

KINGSFIELD ESTATES  
MAYFIELD TOWNSHIP  
GRAND TRAVERSE COUNTY

REPRESENTED BY:



|                              |                |               |
|------------------------------|----------------|---------------|
| DATE: 5-20-03                | JOB NO. 202982 | DRAWN BY: SAJ |
| NOT TO SCALE                 |                | CHECKED: SWJ  |
| FILE: 202982/DESIGN/LOTS.DWG |                | PAGE: 1 of 1  |